

## (1+1) ×1 Multimode Pump Combiner (MPC)



Mode: MPC-(1+1) ×1-940-105/125-1064-6/125-1m-50×5×5

### ◆ Specification:

Parameter	Unit	Values
Product Number	-	MPC-(1+1) ×1-940-105/125-1064-6/125-1m-50×5×5
Signal Wavelength	nm	1020~1080
Input Signal Fiber Type	-	PM980 Panda Fiber
Input Signal Fiber Length	m	> 1.0
Signal Insertion Loss	dB	≤0.5
Pump Wavelength	nm	900~1000
Pump Fiber Type	-	MM-S105/125,0.22NA
Pump Fiber Length	m	> 1.0
Single Port Power Handling	W	≥10
Pump efficiency	%	> 90
Optical Isolation	dB	≥25
Polarization Extinction Ratio	dB	≥20
Output Signal Fiber Type	-	6/125 PM DCF, NA 0.12/0.46
Output Signal Fiber Length	m	> 1.0
Package Size	mm	50(L)×5(W) ×5(H)
Operating Temperature	°C	-5~+70
Operating Humidity	%RH	5~95
Storage Temperature	°C	-40~+85

\*IL is 0.3 dB higher, RL is 5 dB lower, and ER is 2 dB lower for each connector added.

### ◆ Package Dimension:

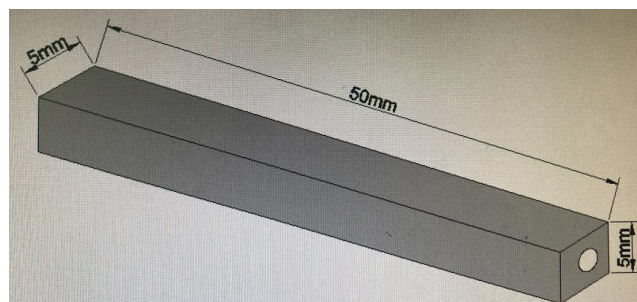

Made By: Li Guang

Checked By: Jimmy Wang

Approved by: Xiao Hai Bo