

Fiber Coupled Acousto Optic Modulator 1550nm 150MHz

Model Number: AOM-1550-150M-05-C2-PM1550-1-1-1-FA

◆ Specification

Parameter	Unit	Value
Material		TeO2
Signal Wavelength (λ_c)	nm	1550
Operating Wavelength Range	nm	± 30
Frequency	Mhz	150
Max. Insertion Loss	dB	3.5
Min. Polarization Extinction Ratio	dB	20
Max. Rise-Time/Fall-Time(10%-90%)	ns	20
Min. Extinction Ratio(1st order On/Off)	dB	45
Max. Voltage Standing Wave Ratio(VSWR)	-	1.5:1
Frequency Shift	Mhz	+ - 150 (Default: +150MHz)
Max. Average Optical Power	W	0.5 or Specified
Peak Power	kW	1
Input Impedance	Ω	50
Max. Radio Frequency Power	W	2.5
Fiber Type	-	PM1550 Panda Fiber with 900 μ m Loose Tube
Pigtail Fiber Length	M	1 ± 0.1
Connector	-	FA/APC
Operating Temperature	$^{\circ}$ C	-10 to +65
Storage Temperature	$^{\circ}$ C	-20 to +70

◆ Package Dimensions

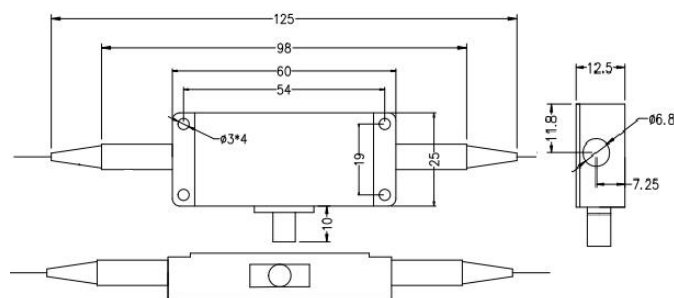

◆ Ordering Information

AOM-①-②-③-④-⑤-⑥-⑦-⑧-⑨

①Center Wavelength	②Frequency	③Handling Average Optical Power	④Package Dimension	⑤Fiber Type	⑥Fiber Length	⑦Fiber Jacket	⑧ Jacket Length	⑨Connector
1064-1064nm	80-80M	05-500mW	C1-67*23*15mm	PM980-PM980	1-1M	0-Bare Fiber	1-1M	FU-FC/PC
1550-1550nm	150-150M	10-1W	C2-45*28*12mm	PM1550-PM1550	S-Specify	1-900 μ m Loose	S-Specify	FA-FC/APC
S-Specify	200-200M	20-2W	S-Specify	S-Specify		2-2mm Cable		S-Specify